



SUPER SLEEPER

Composite Retaining Wall



Find us at:

www.supersleepers.com.au

Contact us:

info@supersleepers.com.au

07 3074 9476

Follow us:

 [supersleeperau](https://www.facebook.com/supersleeperau)

 [supersleeper_au](https://www.instagram.com/supersleeper_au)

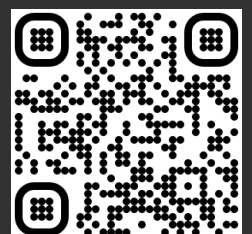

EASIER. FASTER. STRONGER.

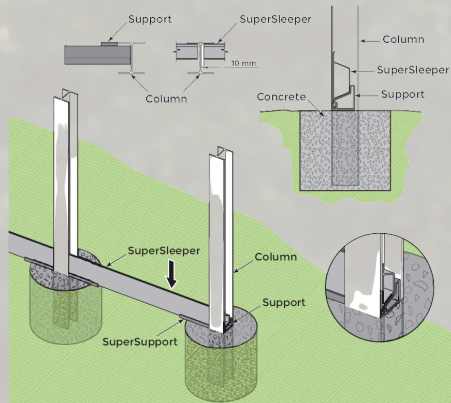

Installation of the Support and the bottom Super Sleeper Super 100™

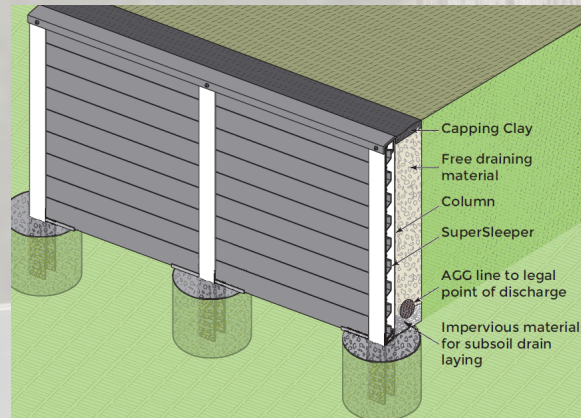

Installing the Drainage System

Single Tier Retaining Wall – Soil Type 1.1 – 5kPa

(includes allowance for 1800mm high fence with wind region B with full shielding)

No. of Sleepers	Wall Height "H"	Footing Depth 'D'	Footing Spacing 'S'	Intermediate Post	Pile Dia. 'PD'	End Post	Post Embedment
1	400	600	2400	120 UB SuperPost	300	100 PFC SuperPost	'D' – 200
1	600	800	2400	120 UB SuperPost	450	100 PFC SuperPost	'D' – 200
1	800	1000	2000	120 UB SuperPost	450	100 PFC SuperPost	'D' – 200
1	1000	1200	2000	120 UB SuperPost	450	100 PFC SuperPost	'D' – 200

Site Properties – Geotechnical Report – Material – Material to be confirmed by professional engineer

Unit Weight	19kN/m
Friction Angle	26°
Drained Cohesion, C'	5 kPa
In situ Backfill	-
Surcharge (Transient)	5 kPa

Note:

- All sleepers on the table above are by Super Sleeper Composite Sleepers
- The tables are presented as a guide for a specific soil conditions. It is important to recognise that foundation depth can change based on soil conditions encountered on site.
- Refer to Super Sleeper install drawings for details
- Refer to Super Sleeper latest technical manual

SUPERIOR CHOICE

- Super Sleeper is a durable, sustainable and cost-effective solution for retaining walls.
- It is protected by a UV coat and fire resistant properties, making it able to withstand the harshest Australian Conditions.
- Super Sleeper is designed for a 100 year life on the engineering in accordance with Australian Standards.

REVOLUTIONARY DESIGN

- Super Sleeper was designed to exceed Australian standards by registered and international certified Chartered Engineers.
- Testing has been undertaken by a third-party NATA accredited laboratory and QUT.
- Designed with the latest innovative software and tested to ensure deflection is within limits to enhance the aesthetics of the retaining wall.
- Each sleeper weighs less than 6kg, making for quick and easy installation, saving time and money.



BOARD OF
**PROFESSIONAL
ENGINEERS**
OF QUEENSLAND

