



# aes

HAPPY,  
HEALTHY,  
EFFICIENT  
HOMES



Effortlessly Cool Summers  
Wonderfully Warm Winters  
Fresh Air All Year Long

Temperature & Zone  
Controlled  
Ducted Heating, Cooling  
& Ventilation Systems

anywAIR<sup>®</sup> technology

# Features

## Easy To Use Touch Pad

Mounted portrait or landscape to the wall by a Fujitsu Installer, the anywAiR® technology ducted zone controller is simple to set-up using a Google Play Store account. The touch pad is the central point from which to operate the system and can be used to manage a variety of Android apps such as weather, recipes, music and other home automation apps.



## Control Up To 10 Zones From Anywhere

The Fujitsu General anywAiR® technology ducted zone controller provides Wi-Fi control for Fujitsu ducted heating/cooling systems via a wall mounted touch pad. Remote access is available using the anywAiR® App\*, giving control of your ducted system anytime, anywhere with selected smartphone and tablet devices. The new technology enables you to run your ducted system efficiently and easily, by controlling up to 10 different zones within your home.

## Simple Control Features

Basic control features of the anywAiR® technology ducted zone controller include:



### Temperature Controlled VAV\*

Control temperature and air flow in up to 10 zones



### Create up to 12 scenarios

Program scenes through custom settings

0-100%

### Variable Air Volume (VAV)#

Select the percentage of air flow for each zone



### Timers

Turn the unit on/off after a set time



### Touch Pad runs other android apps

Such as weather, recipes and music

# Why choose Fujitsu from AES?



Specialist expertise



Advanced Air Filters



New Zealand's only accredited installation programme



6 Year Manufacturer's Warranty



Trusted brand



Fujitsu's Catechin Filters are approved by the Asthma and Respiratory Foundation NZ's Sensitive Choice® programme.



Fujitsu is recommended by Asthma New Zealand

# New Zealand's Most Trusted Heat Pump Brand

We are proud to have been voted the most trusted Heat Pump brand in the 2020 Reader's Digest Trusted Brands Survey.





### Automated Programmable Scenes

Create up to 12 custom scenes to run a series of commands at the touch of a button or at a chosen time. Commands can include turning the unit on and off, changing the mode or temperature, and selecting which zones are open. Scenarios such as going to work, coming home or bedtime can be programmed to control the air flow and temperature to rooms required at set times.

### Variable Airflow (VAV)\*

Variable Air Volume (VAV) control allows the user to select the percentage of air flow for each zone from 0 to 100 percent, in 5 percent increments. This gives you greater control of air flow to each zone to better meet your comfort needs.

### Temperature Controlled VAV\*

Temperature Controlled VAV is available to zones which have the temperature sensor installed.

This feature allows the user to choose the desired temperature for a zone and the system will automatically adjust the air flow to assist in maintaining each zone's desired temperature.

### Wall Mounting Options

Your anywAiR® touch pad is permanently attached to your wall with the ability to pivot between portrait and landscape modes so that you can enjoy all your apps in the orientation that suits them best. To be installed by a Fujitsu Installer only.

### Zone Setting/Dimensions

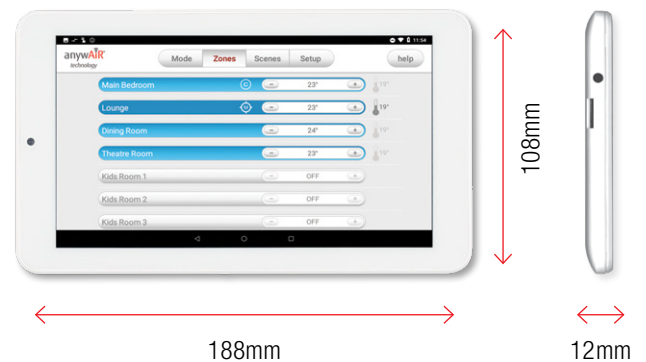

### Zone Control - Turn Rooms On / Off\*

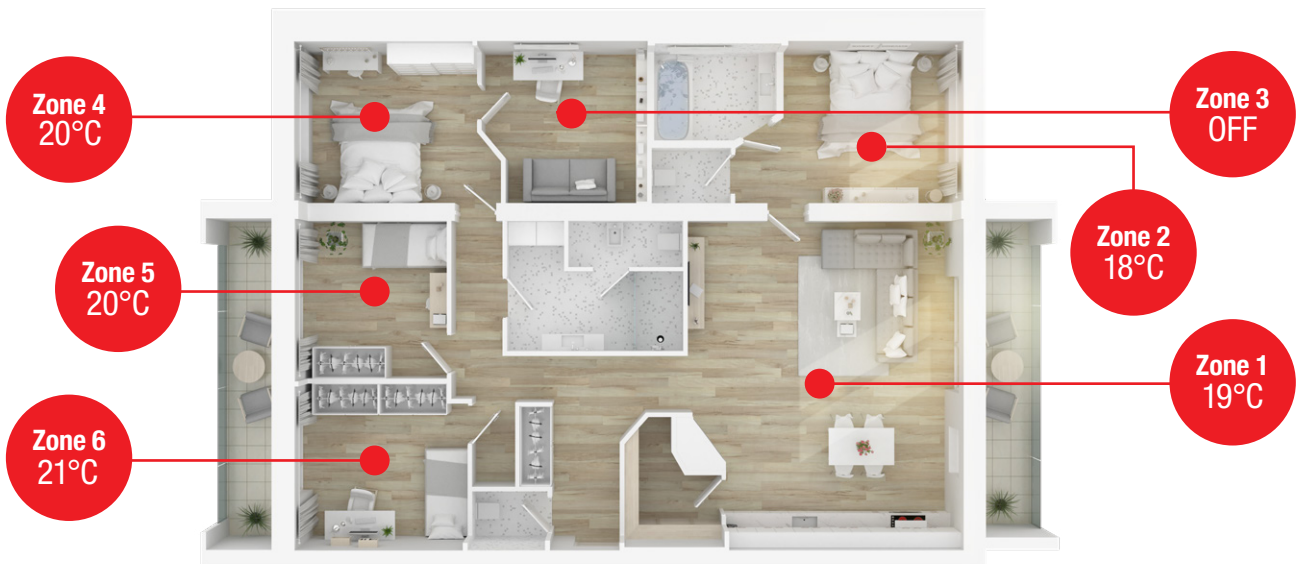

### WiFi / App Control

1. Download the anywAiR® App from the App store or Google Play
2. Follow the App configuration steps
3. Once set up, the anywAiR® App interacts with the anywAiR® technology ducted zone controller to remotely control your ducted system.

\*The anywAiR® App is only compatible with a selected range of Fujitsu General ducted systems when the optional anywAiR® technology Wi-Fi ducted zone controller is installed. It is not a standard inclusion when purchasing a Fujitsu ducted system and must be installed by a Fujitsu Installer.  
 ^Requires optional individual room sensors to be installed. #VAV control is achieved by adjusting the opposed blade damper to control the airflow. The airflow fan setting (high/med/low/auto) of the system works independently to this function. Copyright© 2020 Fujitsu General New Zealand. All rights reserved. Actual products' colours may be different from the colours shown in this printed material. UTY-ANY1. App Store is a service mark of Apple Inc. ©2020 Google LLC All rights reserved. Google Play and the Google Play logo are trademarks of Google LLC. Other trademarks and tradenames are acknowledged to be the copyright of their respective holders.

## Actual Touch Panel Size

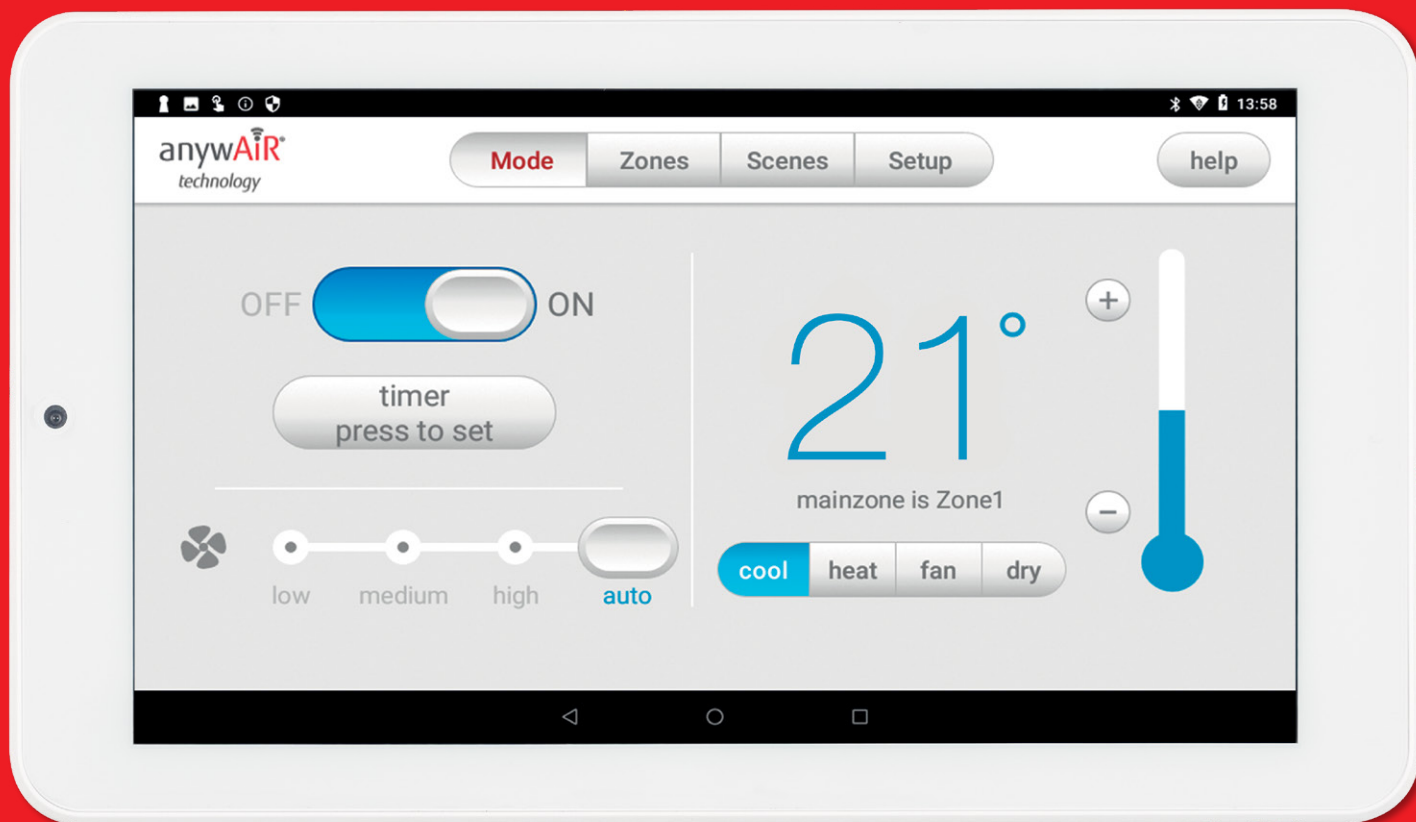

- **Enjoy Effortlessly Cool Summers + Wonderfully Warm Winters!**
- **Set Different Room Temperatures + Turn Rooms On / Off**
- **Automatic Airflow Adjustment Per Room (Variable Airflow)**
- **WiFi / App Control (Apple + Android)**
- **Integrated Fresh Air Ventilation Option (No HRV/DVS Needed!)**
- **In-Ceiling / Under-Floor / Grille Options**
- **AES Has Installed Over 1,000 Ducted Systems Since 2014**

**Central      09 575 1191**  
**North        09 486 4387**  
**West         09 836 0133**  
**South        09 263 8687**

**happy@aes.nz**

**www.aes.nz**

**happy, healthy, efficient homes**